



INSTRUCTION MANUAL

CZECH UP YOUR BEER
COOLING AND DISPENSING SYSTEMS

SODA WATER MAKERS
LINDR

ENGLISH

Number 015-2020 REV00

Valid 2020-07-01



LINDR.CZ s.p.o.
CHLADICÍ A VÝČEPNÍ TECHNIKA

IMPORTANT

This manual contains instructions for installation, use and operation of the appliance. This manual is an integral part of the device. It must be stored in the vicinity of the device for the entirety of its service life and must be made available to the user any time the device is installed, moved, used or maintained. Read this manual carefully before installing and using the device. It contains important information necessary to ensure that all operations are done properly and safely.

This manual is a translation of the original Czech manual.

LINDR.CZ s.r.o.

Sadová 132
503 15 Nechanice, Czech Republic

mob.: + **420 775 715 494**

tel. : +420 495 447 239

e-mail: info@lindr.cz

web: www.lindr.cz, www.lindr.eu

SYMBOLS AND MARKINGS USED IN THE MANUAL:



WARNING:

Not following instructions may cause injury or damage the device.



DANGER:

Risk of injury by electrical current.



NOTE:

This symbol indicates information and recommendations for the user.



WARNING:

The cooling system contains flammable coolant R290 (propane)!





Obsah:

1.	Introduction	4
2.	Description of the device	4
3.	Machine plate	4
4.	General instructions, measures and safety instructions	4
5.	Installation and placement	5
6.	Electrical connection	6
7.	Testing	6
8.	Warranty	6
9.	Connection and pressuration	6
10.	Temperature and adjustment	10
11.	How to work with speed fittings	10
12.	Water pressure reducer	11
13.	Keg coupler assembly	11
14.	Keg tapping and untapping	12
15.	Putting into operation	15
16.	Recommended accessories	15
17.	Table of malfunctions	16
18.	Spare parts	17
19.	Cleaning the condenser	17
20.	Inspection before every use	17
21.	Periodic checks	18
22.	Maintenance	18
23.	Environmental protection	18
24.	Technical data	19

1. INTRODUCTION:

Thank you for purchasing this LINDR product.

2. DESCRIPTION OF THE DEVICE:

Soda Water Makers:

Soda Water Makers are the professional devices designed for producing chilled soda water by mixing H₂O and CO₂.

These practical devices can be used in households, offices, restaurants, production facilities and more.

This manual is intended for models:

SODA PYGMY GREEN LINE

SODA PYGMY 25 GREEN LINE

SODA AS-45 GREEN LINE

SODA AS-110 GREEN LINE

EXTERNAL SODA WATER MAKER

3. MACHINE PLATE:



4. GENERAL INSTRUCTIONS, MEASURES AND SAFETY INSTRUCTIONS:

When using the device, follow basic safety instructions stated by the manufacturer. Any other use is considered impermissible and therefore dangerous. The supplier is not liable for damage caused by incorrect use.

DO NOT USE THE DEVICE FOR PURPOSES OTHER THAN THOSE STATED BY THE MANUFACTURER!

General safety principles. Observe the following safety instructions.

The supplier is not liable for damage caused by activities carried out on this device without observing the following instructions!

⚠ WARNING: Children aged 15 or more and persons with reduced physical, sensory or mental capabilities or insufficient experience and knowledge may only use the device when supervised or instructed in safe use of the appliance and familiarised with potential dangers.

⚠ WARNING: Children must not be allowed to play with the appliance. Store all packaging material out of reach of children (comes with a plastic bag – suffocation hazard).

⚠ WARNING: Cleaning and maintenance of the appliance on the part of the user must not be done by unsupervised children.

⚠ WARNING: Before connecting to main electrical supply, check that the voltage and frequency in the mains corresponds to the data stated on the device.

⚠ WARNING: Always make sure that the socket you intend to plug the cooler into meets the specifications on the machine plate (voltage, frequency, input power).

⚠ WARNING: Before performing operations on the device such as cleaning or maintenance, ALWAYS disconnect the device from power supply: set the thermostat to „0” position and unplug the appliance from the socket.

⚠ WARNING: Never place tools or other object into the fan.

⚠ WARNING: Never touch electrical components with wet or damp hands.

⚠ WARNING: To ensure the cooling unit works properly and at full capacity, make sure air supply to the unit is not obstructed.

⚠ WARNING: Water temperature during sanitation must not be higher than 25 °C!

⚠ WARNING: Always make sure the power socket you intend to plug the cooler into is accessible, so that the appliance can be immediately unplugged in case of emergency.

⚠ WARNING: When unplugging the device from the socket, grab the plug and pull it out. Do not under any circumstances pull at the cable; risk of damage.

⚠ WARNING: To turn the device off completely, unplug the appliance from the power socket.

⚠ WARNING: In the event the electrical wiring of the product becomes damaged, summon a trained service technician. Do not under any circumstances repair the device yourself.

⚠ WARNING: The cooling system contains flammable coolant R290 (propane)!



⚠ WARNING: Emergency maintenance and repair of the cooling system must be done by trained, authorised technicians familiar with cooling and electrical systems. The technicians should have special training and qualification for handling flammable substances in order to perform service on coolers containing R290. Follow basic regulations and safety measures regarding service and repair!

⚠ WARNING: Do not use open flame or potential sources of sparks in the vicinity of a cooler using **R290** coolant!

⚠ WARNING: After unpacking, place the cooler so that heat created by the cooling unit can be vented sufficiently.

⚠ WARNING: Do not place objects that could prevent air circulation on top of the cooler.

5. INSTALLATION AND PLACEMENT:

Place the device onto a stable, level surface (maximum permitted inclination: 2 degrees). The appliance requires unobstructed air circulation.

- Ensure sufficient free space for air circulation and heat dissipation.
- Ensure sufficient supply of fresh air.
- The device must not be placed in an enclosed space.
- The device must not be placed in the vicinity of heat sources or exposed to direct sunlight.

Minimum distance of vents from an obstacle that would limit air circulation must be 30 cm. Minimum distance for sections with no air vents is 7 cm. Ideally, use the device in a cool and well-ventilated room. The device is designed for use at ambient temperature of at least 16 °C and at most 32 °C.

⚠ WARNING: The device MUST NOT be used or stored at ambient temperature lower than 0 °C. The device is designed for use in a normal environment, always under a roof, protected from rain or sunlight. Climate class N. .

⚠ DANGER: Protect the device and electrical connection from rain and spraying water!

⚠ WARNING: Do not under any circumstances lay the device on its side, not even during transport.

i NOTE: In order for the device to work correctly and at maximum output, it is important to not cover up any of the device's vents and ensure sufficient air circulation.

6. ELECTRICAL CONNECTION :

Connect the device to a power socket in accordance with specifications on the machine plate of the device. Electrical wiring is subject to local regulations. If the power leads (cables) are damaged, they must be replaced by the manufacturer, their service technician or a similarly qualified person to prevent risk of hazardous situations.

⚠ DANGER: Do not use or turn on the device if the power lead (cable) is damaged!

7. TESTING:

The product is delivered ready for immediate use.

8. WARRANTY:

The device comes with a warranty in accordance with general legal regulations of the Czech Republic or in accordance with the trade agreement. During the validity period of the warranty, we will remove any defects on the product free of charge, provided these defects were not caused by excess wear, improper handling, incorrect storage or by using the

product in a way that is counter to the instruction manual or the product's design as defined by the manufacturer. Materials replaced during the validity period of the warranty are our property. The legitimacy of the warranty claim is always decided by an authorised service centre. Warranty provided by a retailer outside of the territory of the Czech Republic is governed by the agreement between the retailer and the buyer in their mutual relationship; this agreement is not directly linked to the manufacturer. The agreement does not give the buyer the right to submit warranty claims to the manufacturer. Transport expenses or other costs are not covered by the warranty.

ATTENTION:

Electrical devices and appliances must be checked/inspected at a time stipulated by valid legislation of the country the device is operated in. Inspection of wiring may only be done by a person with valid authorisation for this activity. Service work, provision of spare parts and inspection is done by the manufacturer or an authorised service centre.

9. CONNECTION AND PRESSURISATION:

9.1 Connection and Pressurisation SODA PYGMY GREEN LINE

1. Water inlet 3/8
2. Inlet of CO₂
3. Pressure reducer CO₂
4. Pressure reducer for water
5. Water Filter
6. Main water connection (drinking water)
7. Aqua Stop (recommended)
8. Water hose
9. CO₂ hose

figure 6 A

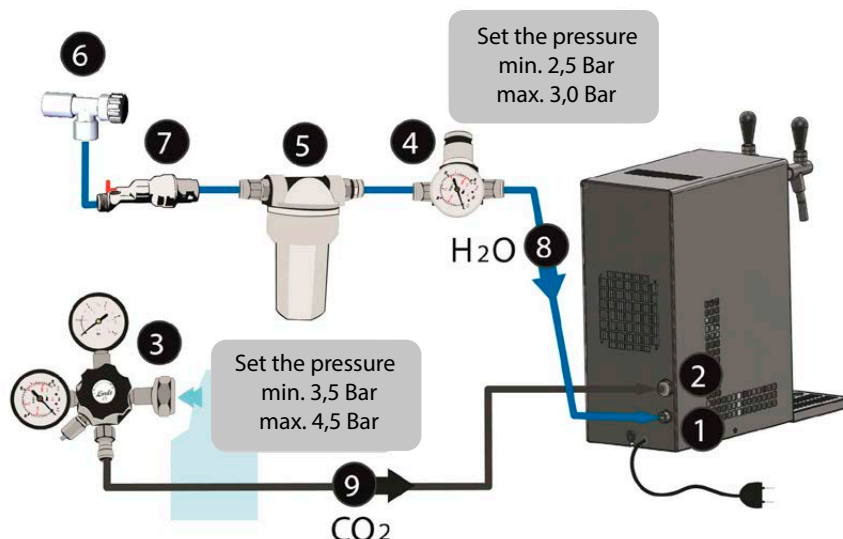

9.2 Connection and Pressurisation SODA PYGMY 25 GREEN LINE

- | | |
|-------------------------------------------|-----------------------------------------------------|
| 1. Water inlet | 7. Water hose |
| 2. Inlet of CO ₂ | 8. CO ₂ hose |
| 3. Pressure reducer CO ₂ | 9. Python |
| 4. Water Filter | 10. Speed fitting 9,5 x 8 mm |
| 5. Main water connection (drinking water) | 11. Water outlet for production of cooled water |
| 6. Aqua Stop (recommended) | 12. Water outlet for production of carbonated water |

figure 7A

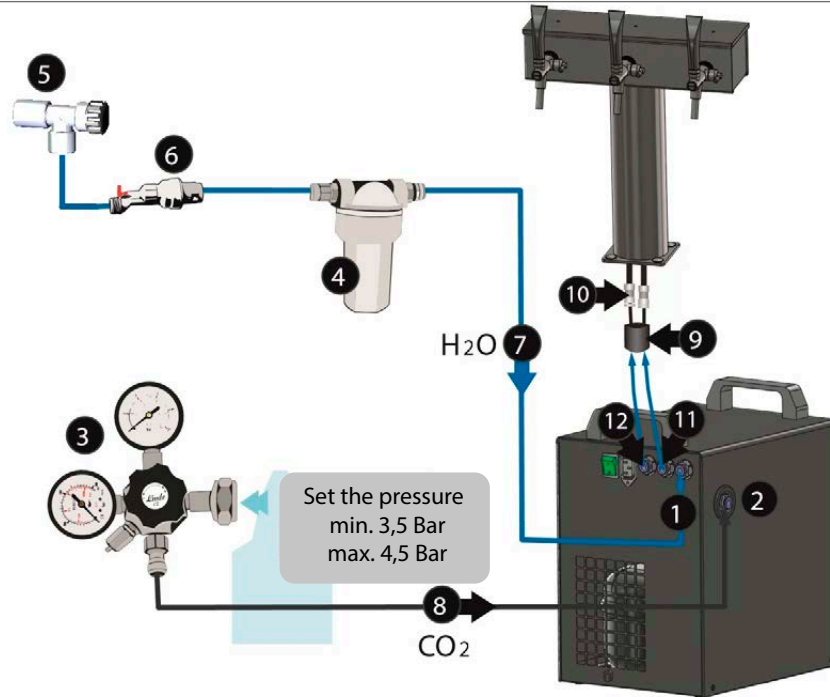

9.3 Connection and Pressurisation SODA AS-45 GREEN LINE

- | | |
|---------------------------------------------------|-------------------------------------------|
| 1. Water inlet for chilling | 7. Water Filter |
| 2. Water inlet for production of carbonated water | 8. Main water connection (drinking water) |
| 3. Inlet of CO ₂ | 9. Aqua Stop (recommended) |
| 4. Pressure reducer CO ₂ | 7. Water hose |
| 5. Y 8 x 8 x 8 mm speed fitting | 8. CO ₂ hose |
| 6. Pressure reducer for water | |

figure 7B

Variant A: SODA WATER / COLD WATER

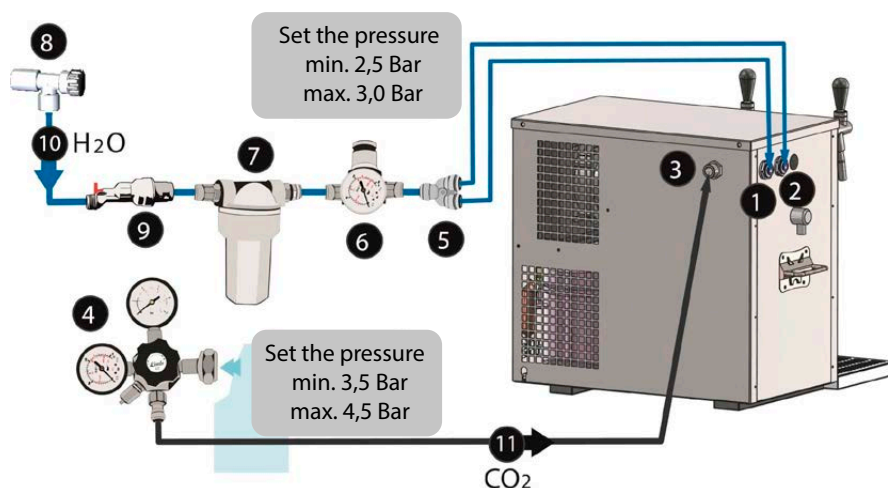

9.4 Connection and Pressurisation SODA AS-45 GREEN LINE

- | | |
|---------------------------------------------------|-----------------------------------------------|
| 1. Beverage inlet for chilling | 7. Main water connection (drinking water) |
| 2. Water inlet for production of carbonated water | 8. Keg coupler (A-system, S-system, M-system) |
| 3. Inlet of CO ₂ | 9. Beverage |
| 4. Pressure reducer for 2 st. CO ₂ | 10. Aqua Stop (recommended) |
| 5. Pressure reducer for water | 11. Water hose |
| 6. Water Filter | 12. CO ₂ hose |

figure 8 A

Variant B: SODA WATER / BEVERAGE

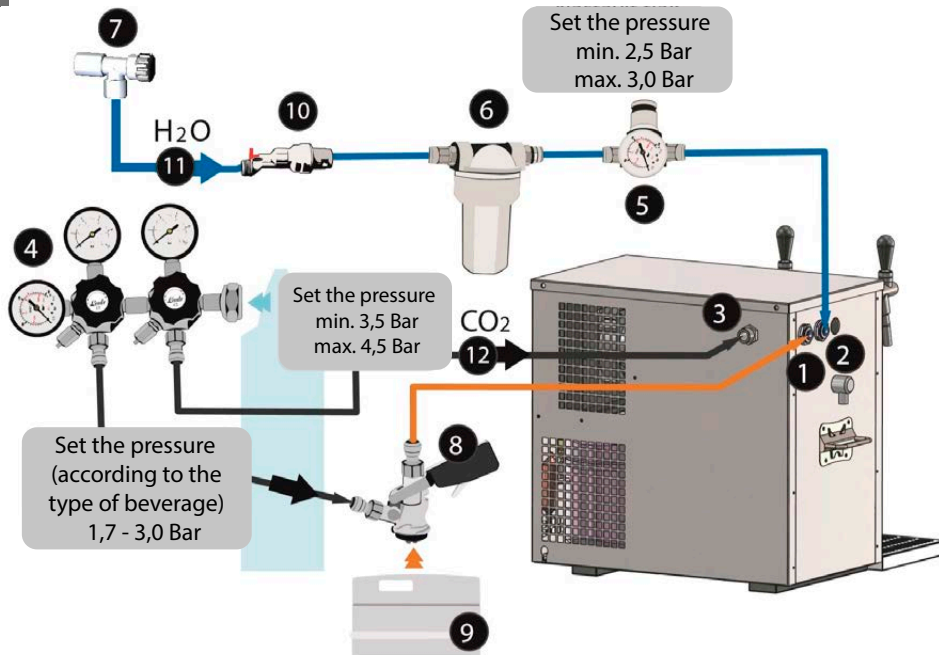

9.5 Connection and Pressurisation EXTERNAL SODA WATER MAKER

- | | |
|-------------------------------------------|-------------------------------|
| 1. Water inlet | 7. Pressure reducer for water |
| 2. Inlet of CO ₂ | 8. Outlet SODA |
| 3. Pressure reducer CO ₂ | 9. Water hose |
| 4. Water Filter | 10. CO ₂ hose |
| 5. Main water connection (drinking water) | 11. Switch On/ Off |
| 6. Aqua Stop (recommended) | 12. Cooler |

figure 8 B

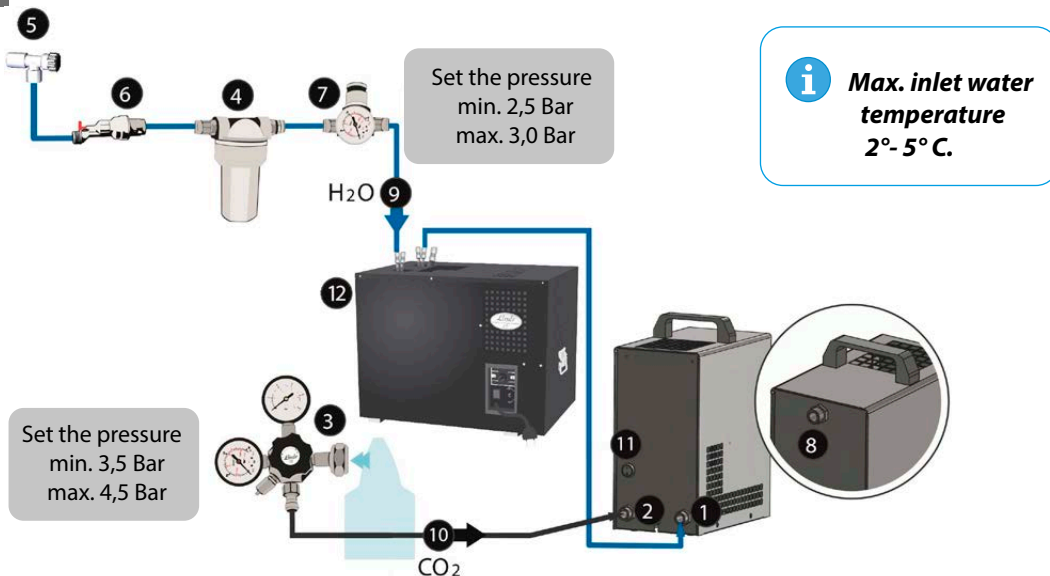

9.6 Connection and Pressurisation SODA AS-110 GREEN LINE

- | | |
|------------------------------------------------|------------------------------------------------|
| 1. Water inlet | 10. Pressure reducer for water |
| 2. Inlet of CO ₂ | 11. Pressure reducer for 2 st. CO ₂ |
| 3. Water inlet for chilling | 12. Y 8 x 8 x 8 mm speed fitting |
| 4. Cooling (IN / OUT) | 13. Keg coupler (A-system, S-system, M-system) |
| 5. Water outlet for production of cooled water | 14. Beverage |
| 6. Beverage 1, 2 - outlet | 15. Python |
| 7. Main water connection (drinking water) | 16. Speed fitting 9,5 x 8 mm (3x) |
| 8. Aqua Stop (recommended) | 17. Speed fitting 9,5 x 8 mm (2x) |
| 9. Water Filter | 18. Water hose |
| | 19. CO ₂ hose |

figure 9 A

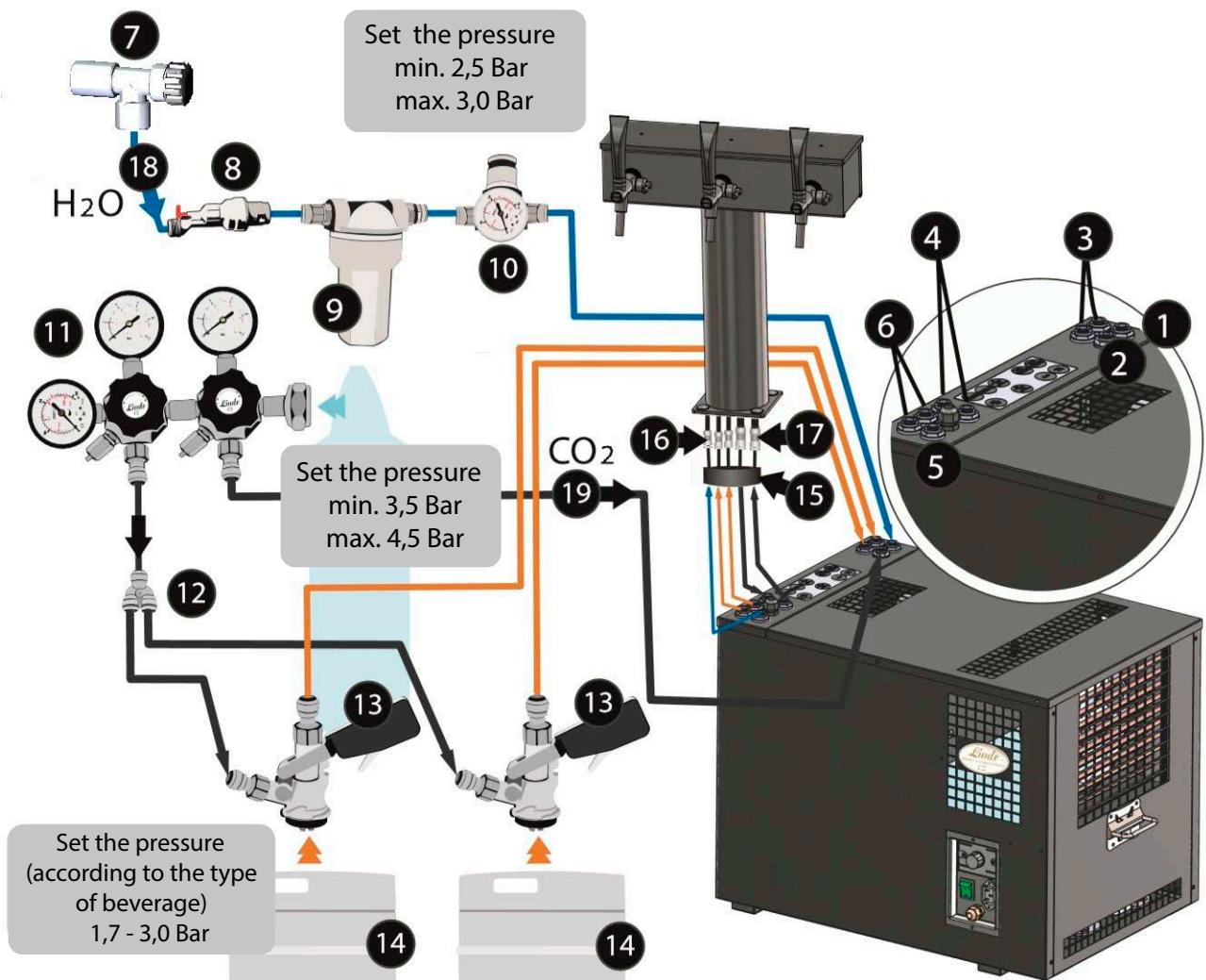

⚠ WARNING: Check the level and cleanliness of the water bath in the plastic container (SODA AS-45 GREEN LINE a SODA AS-110 GREEN LINE) (after six months of operation we recommend to replace the water bath).

10. TEMPERATURE AND ADJUSTMENT :

The temperature of the cooled beverage is controlled by a mechanical thermostat in temperature range of 2 °C to 8 °C. The thermostat has a numerical scale of 1-7.

figure 10 A



0 = OFF

figure 10 B



1 = MAX. BEVERAGE TEMPERATURE (8°C)

figure 10 C



7 = MIN. BEVERAGE TEMPERATURE (2°C)

11. HOW TO WORK WITH SPEED FITTINGS:

11.1 Speed Fitting Installation:

figure 10 D

Grasp the speed fitting and insert the hose all the way inside the speed fitting body (ca. 20 mm). The end of the hose must be straight so that it plugs fully into the coupling. If the hose will not go in, moisten the end of the hose.

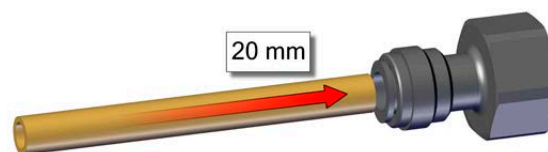

11.2 Speed Fitting Removal:

figure 10 E

Hold the grey ring tight against the body of the speed fitting and pull the hose.

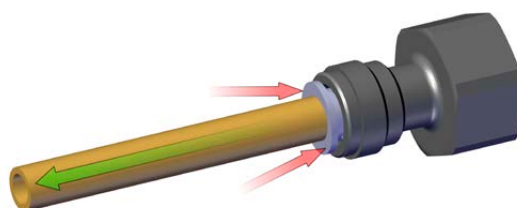

⚠ WARNING: If you do not hold the grey ring but pull at the hose, the speed fitting will cut even deeper into the hose.

⚠ WARNING: Hoses must not be pressurised during removal.

12. WATER PRESSURE REDUCER:

The MRA 1 / 4-8m regulator is recommended for the correct operation of the device.

(for SODA PYGMY 25 GREEN LINE it is part of the device)

1. regulator
2. speed fitting JG M 1/4 x 9,5 mm
3. manometer

figure 11 A

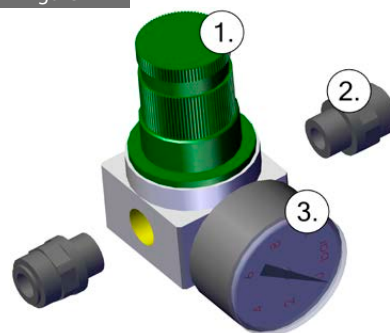

13. KEG COUPLER ASSEMBLY:

13.1 Outlet for Keg Pressurisation:

Variant of connection with the use of a bushing; the hose is fitted onto the bushing and affixed with a clip.

figure 11 B

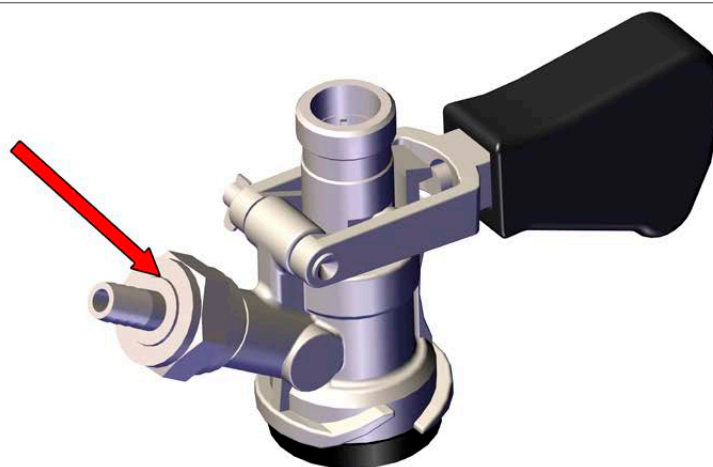

figure 11 C

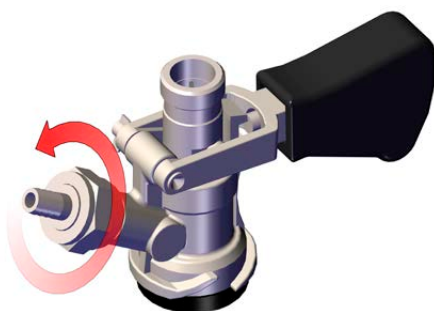

figure 11 D



figure 11 E

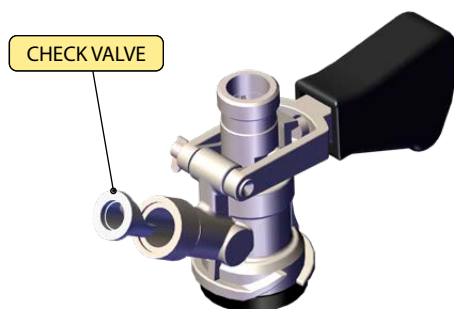
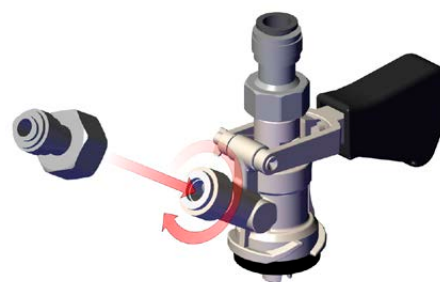

figure 11 F



⚠ WARNING: Before you screw the speed fitting onto the 5/8" thread, make sure the keg coupler (air inlet for delivery medium) has a lip valve (check valve) fitted on it.

11.2 Outlet for Beverage :

Screw an F 5/8" x 3/8" (9,5 mm) speed fitting onto the keg coupler.

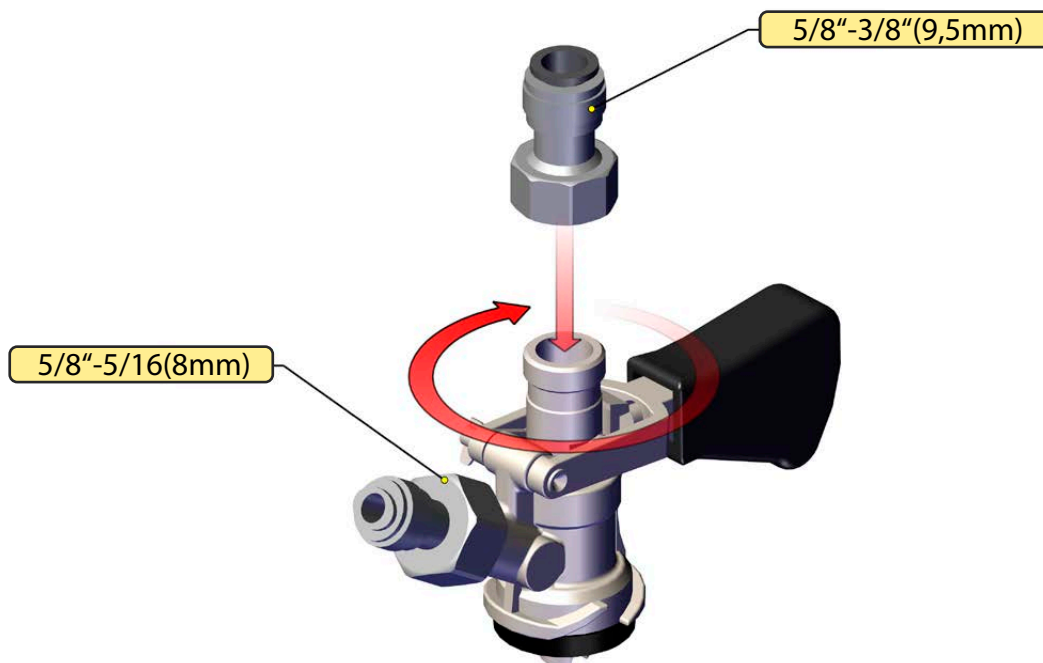

12

14. KEG TAPPING AND UNTAPPING:

14.1 Keg Tapping:

Procedure for tapping a keg using an S-system keg coupler:

⚠ WARNING: Make sure the adapter is clean before tapping the keg!

S-system keg coupler

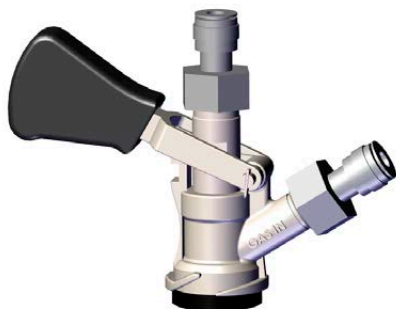

figure 13 A

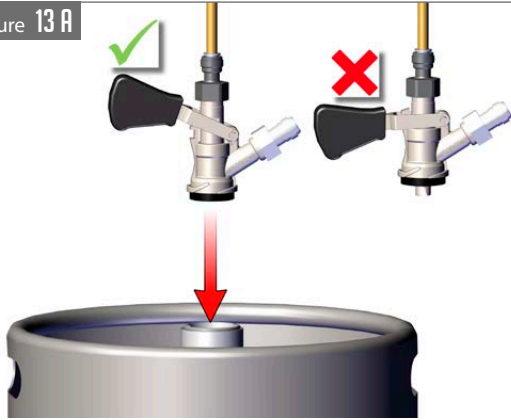

figure 13 B

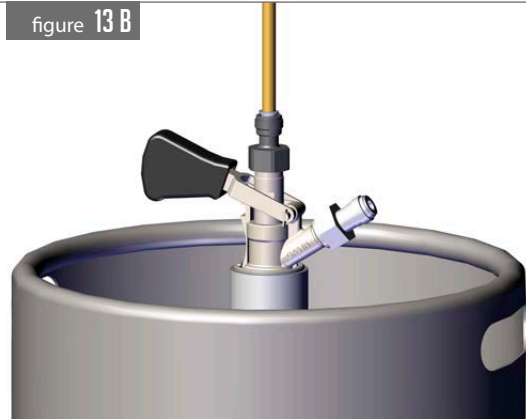

figure 13 C



figure 13 D

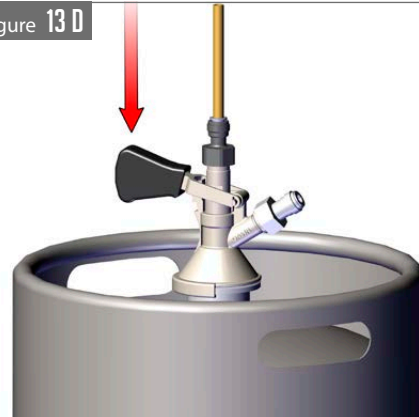
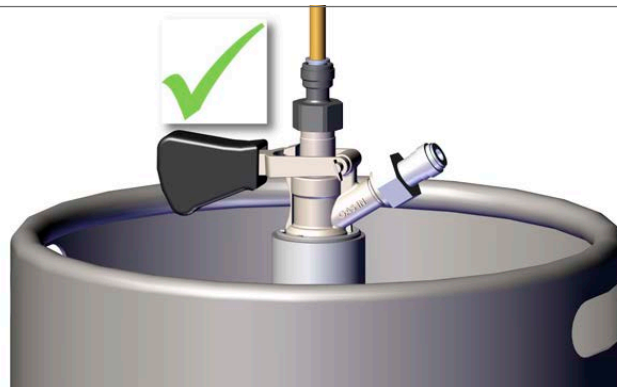

figure 13 E



14.2 Keg Untapping:

Procedure for untapping a keg using an S-system keg coupler:

figure 13 F

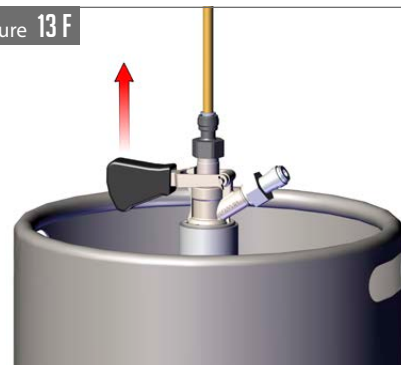
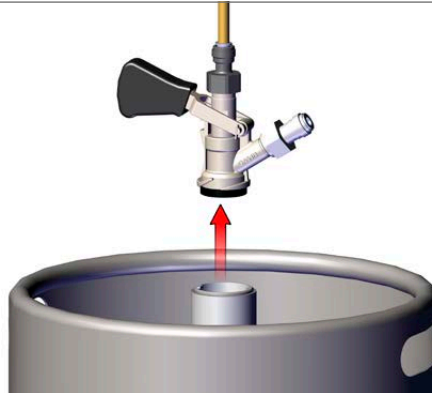

figure 13 G



figure 14 A



14.3 Keg Tapping:

Procedure for tapping a keg using an A-system keg coupler:

⚠ WARNING: Make sure the adapter is clean before tapping the keg!

A-system keg coupler

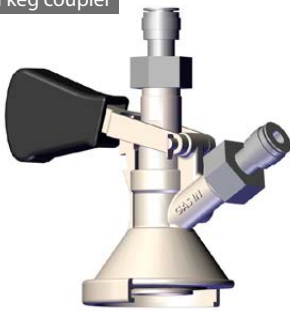

14

figure 14 B

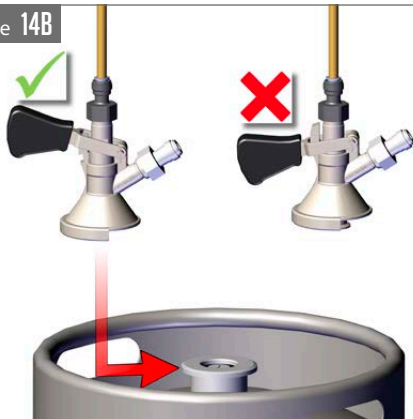

figure 14 C

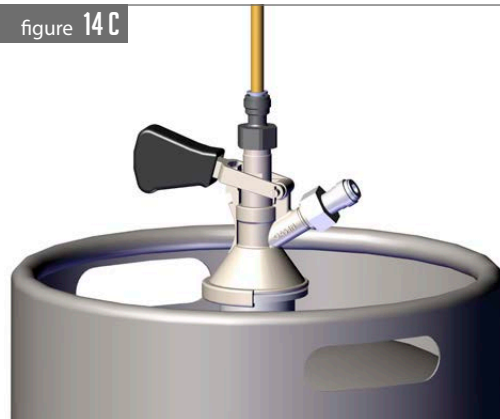

figure 14 D

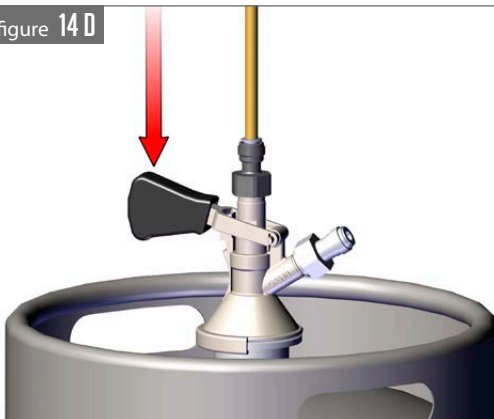
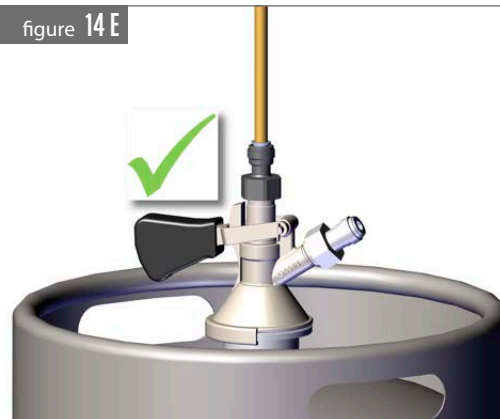

figure 14 E



14.4 Keg Untapping:

Procedure for untapping a keg using an A-system keg coupler:

figure 15 A

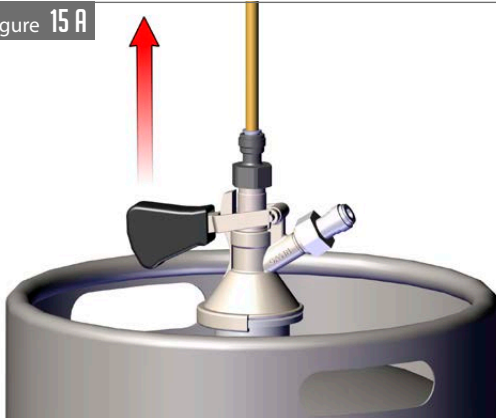
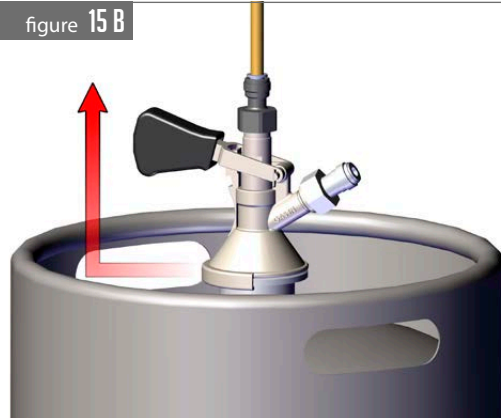

figure 15 B



15. PUTTING INTO OPERATION:

1. Connect the device to CO2 supply.
2. Connect the device to water supply.
3. Check that all the joints and connections are sufficiently tight.
4. For SODA AS-45 GREEN LINE and SODA AS-110 GREEN LINE, fill the cooling tank with clean water up to the overflow.
5. Connect the device to the power mains.
6. Switch on the device with the main switch (use thermostat for the SODA PYGMY GREEN LINE model).
7. You can use the tap to dispense a drink.



Max. inlet water temperature (beverages) 25 °C.



WARNING: If you discover a leak, turn off the device. Fix any leaks found on the tubing. If a leak is found inside the device or you are unsure how to proceed, contact a service centre.

16. RECOMMENDED ACCESSORIES:

- AquaStop
- Water filter (is required for the correct operation of the device)
- Water pressure reducer (is required for the correct operation of the device)
- Tubes and fittings



NOTE: The recommended accessories are not included. The supplier is not liable for damages caused by not using this recommended accessory.

17. TABLE OF MALFUNCTIONS:

Malfunction	Cause	Removal
The soda water does not flow.	Pressure at the inlet has exceeded 3.0 bar.	Reduce the pressure on the water valve min. to 2.5 Bar.-max 3.0 Bar.
	No water supply to the water tap.	Open the valve on the water tap.
	Inlet of pressure of CO ₂ is not open.	Open and check the inlet pressure CO ₂ on the cylinder and adjust the pressure of CO ₂ min.to 3.5 Bar - max. 4.5 Bar.
	Water filter blocked.	Check or replace the water filter.
The beverage is chilled only a little.	Wrong setting of the thermostat.	Turn the thermostat knob clockwise to No. 7.
	Bad air circulation.	Make sure the condenser plate are not clogged
	The machine overheats.	Place the machine to a cooler surroundings.
The fittings do not seal properly.	Poorly inserted tube.	Pull out the tube, check to see if there are not any sharp edges, possibly shorten with knife.
	Scratches on the hose.	Pull out and shorten for about 2cm.



NOTE: If the defect persists even after the above steps are taken, contact a service centre.

Do not forget to specify the following:

- type of defect
- product type
- production year
- product's serial number (found on the machine plate)

Ordering Components:

ALWAYS USE ORIGINAL COMPONENTS. The manufacturer or supplier bear no responsibility for non-original components or components not recommended by the manufacturer.

18. SPARE PARTS:

When ordering spare parts, always provide the following:

- product type
- production year
- product's serial number

19. CLEANING THE CONDENSER:

The condenser must be cleaned with compressed air 1x a month. Alternatively, clean from the outside with a brush.

20. INSPECTION BEFORE EVERY USE:

1. Visual check.
2. Lead-in cable check.
3. Condenser cleanliness check (in case of excess pollution of the condenser, clean more frequently than 1x a month).

 **WARNING:** Do not use the device if defects or malfunctions are found.

21. PERIODIC CHECKS:

- ✓ 1x a week: check that the lead-in cable is undamaged and that the plug is firmly in the socket.
- ✓ 1x a week: check that the device is not exposed to radiant heat.
- ✓ 1x a week: check that air circulation is not obstructed.
- ✓ 1x a month: check the cooling unit's condenser and clean it regularly.
- ✓ 1x a year: have an engineering inspector check the electrical safety of the device.

22. MAINTENANCE:

The condenser must be checked for cleanliness every month. Any dirt found must be cleaned with compressed air or wiped off. Otherwise, there is a risk of reduced cooling output or damaging of the cooler.

Wipe the device only with a soft and, if needed, lightly moistened cloth.

23. ENVIRONMENTAL PROTECTION:

Waste Sorting:



This product must not be disposed of in communal waste. Electrical waste in the Czech Republic is disposed of within the Rema System (www.remasystem.cz).

In countries other than the Czech Republic, waste sorting is subject to local regulations.



Sorting waste allows recycling and reusing used products and packaging materials. Reuse of recycled material helps protect the environment from pollution and reduces resource consumption. Local regulations may regulate the method of disposing of household appliances at local collection points or at the point of sale.

24. TECHNICAL DATA

PRODUCT MODEL	COOLING POWER OF THE COMPRESSOR (HP)	COOLING POWER OF THE COMPRESSOR (W)	MAXIMUM COOLING CAPACITY (L/ HOUR) TO 0°C/ TK 45°C	CONTINUOUS COOLING PERFORMANCE (L/HOD)	NUMBER/ LENGTH OF COOLING COILS (m)	NUMBER OF TAPS (PCS)	THERMAL GRADIENT Δt (°C)	VOLTAGE	POWER (W)	AMPERAGE (A)	DIMENSION OF THE CABINET (WxDxH MM)	TYPE OF REFRIGERANT	NET WEIGHT (KG)
SODA PYGMY GREEN LINE	1/8	310	25	20	1/11,0	2	10	220-240V 50Hz~1	391	1,70	180x300x420	R290	19,0
SODA PYGMY 25 GREEN LINE	1/8	310	20	20	1/10,5	-	10	220-240V 50Hz~1	391	1,70	240x315x335	R290	17,0
SODA AS-45 GREEN LINE	1/8	310	45	25	1/7,0	2	10	220-240V 50Hz~1	299	1,50	440x270x430	R290	24,0
SODA AS-110 GREEN LINE	1/3	860	110	60	2/16,0	-	10	220-240V 50Hz~1	943	4,10	610x420x475	R290	38
EXTERNAL SODA WATER MAKER	-	-	40	35	-	-	10	220-240V 50Hz~1	345	1,50	170x280x325	-	10,0

