



CZECH UP YOUR BEER
COOLING AND DISPENSING SYSTEMS

INSTRUCTION MANUAL

SODA WATER MAKERS LINDR

ENGLISH

Number 011-2020 REV00

Valid 2020-06-01

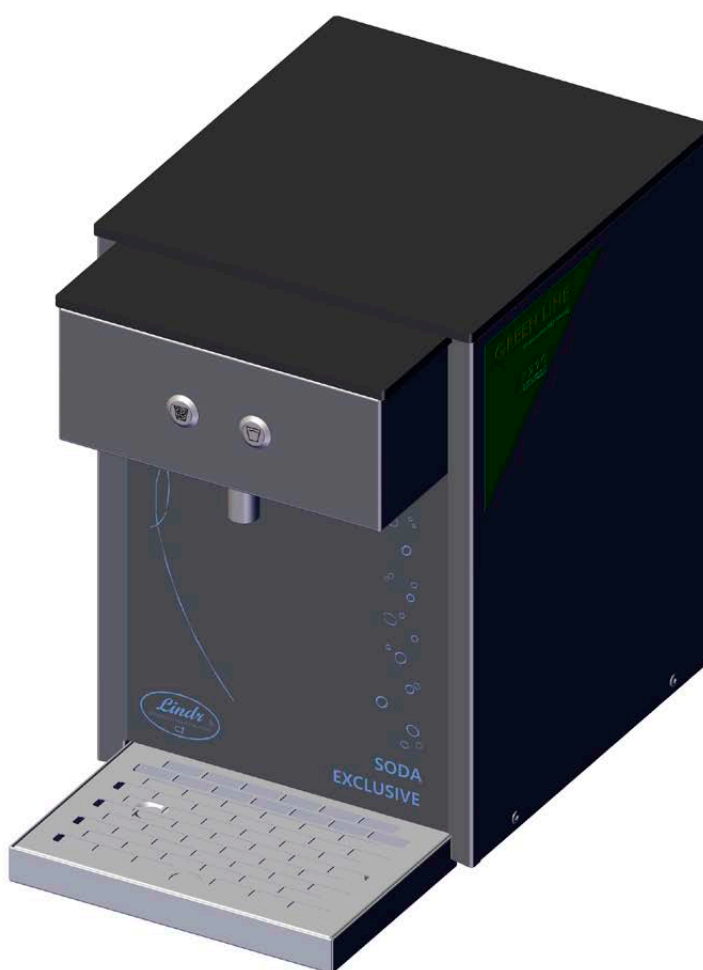

SODA EXCLUSIVE GREEN LINE

LINDR.CZ s.r.o.
CHLADICÍ A VÝČEPNÍ TECHNIKA

IMPORTANT

This manual contains instructions for installation, use and operation of the appliance. This manual is an integral part of the device. It must be stored in the vicinity of the device for the entirety of its service life and must be made available to the user any time the device is installed, moved, used or maintained. Read this manual carefully before installing and using the device. It contains important information for its correct and safe use.

This manual is a translation of the original Czech manual.

LINDR.CZ s.r.o.

Sadová 132
503 15 Nechanice, Czech Republic

mobile: + 420 775 715 494

tel. : +420 495 447 239

e-mail: info@lindr.cz

web: www.lindr.cz, www.lindr.eu

SYMBOLS AND MARKINGS USED IN THE MANUAL:



WARNING:

Not following instructions may cause injury or damage the device.



DANGER:

Risk of injury by electrical current.



NOTE:

This symbol indicates information and recommendations for the user.



WARNING:

The cooling system contains flammable coolant R290 (propane)!





Contents:

1.	Introduction	4
2.	Description of the cooler	4
3.	Machine plate	4
4.	General instructions, measures and safety instructions	4
5.	Installation and placement	5
6.	Electrical connection	6
7.	Testing	6
8.	Warranty	6
9.	Description of the cooler	6
10.	Inlet and outlet marking	8
11.	How to work with speed fittings	9
12.	Putting into operation	9
13.	Connecting SODA EXCLUSIVE	10
14.	Recommended accessories	11
15.	Cleaning the condenser	11
16.	Table of malfunctions	12
17.	Spare parts	13
18.	Technical data	13
19.	Inspection before every use	14
20.	Periodic checks	14
21.	Maintenance	14
22.	Environmental protection	14

1. INTRODUCTION:

Thank you for purchasing this LINDR product.

2. DEVICE DESCRIPTION

Soda Water Maker

SODA EXCLUSIVE GREEN LINE is a professional device designed for producing cooled soda water by mixing H₂O and CO₂. This practical device with unique design can be used in households, offices, restaurants, production facilities and more. The soda water maker is fitted with high-quality buttons for easy control. Its exclusive look is highlighted by a backlit front panel.

3. MACHINE PLATE



4. GENERAL INSTRUCTIONS, MEASURES AND SAFETY INSTRUCTIONS

When using the device, follow basic safety instructions stated by the manufacturer. The cooling device is designed for flow cooling of beverages dispensed from kegs. Any other use is considered impermissible and therefore dangerous. The supplier is not liable for damage caused by incorrect use.

DO NOT USE THE DEVICE FOR PURPOSES OTHER THAN THOSE STATED BY THE MANUFACTURER!

General safety principles. Observe the following safety instructions.

The supplier is not liable for damage caused by activities carried out on this device without observing the following instructions!

⚠ WARNING: Children aged 15 or more and persons with reduced physical, sensory or mental capabilities or insufficient experience and knowledge may only use the device when supervised or instructed in safe use of the appliance and familiarised with potential dangers.

⚠ WARNING: Children must not be allowed to play with the appliance. Store all packaging material out of reach of children (*comes with a plastic bag – suffocation hazard*).

⚠ WARNING: Cleaning and maintenance of the appliance on the part of the user must not be done by unsupervised children.

⚠ WARNING: Before connecting to main electrical supply, check that the voltage and frequency in the mains corresponds to the data stated on the device.

⚠ WARNING: Always make sure that the socket you intend to plug the cooler into meets the specifications on the machine plate (voltage, frequency, input power).

⚠ WARNING: Before any interference with the device, such as cleaning or maintenance, ALWAYS disconnect the device from power supply.

⚠ WARNING: Never place tools or other object into the fan.

⚠ WARNING: Never touch electrical components with wet or damp hands.

⚠ WARNING: To ensure the cooling unit works properly and at full capacity, make sure air supply to the unit is not obstructed.

⚠ WARNING: Water temperature during sanitation must not be higher than 25 °C!

⚠ WARNING: Always make sure the power socket you intend to plug the cooler into is accessible, so that the appliance can be immediately unplugged in case of emergency.

⚠ WARNING: When unplugging the device from the socket, grab the plug and pull it out. Do not under any circumstances pull at the cable; risk of damage.

⚠ WARNING: To turn the device off completely, unplug the appliance from the power socket.

⚠ WARNING: In the event the electrical wiring of the product becomes damaged, summon a trained service technician. Do not under any circumstances repair the device yourself.

⚠ WARNING: *The cooling system contains flammable coolant R290 (propane)!*



⚠ WARNING: Emergency maintenance and repair of the cooling system must be done by trained, authorised technicians familiar with cooling and electrical systems. The technicians should have special training and qualification for handling flammable substances in order to perform service on coolers containing R290. Follow basic regulations and safety measures regarding service and repair!

⚠ WARNING: Do not use open flame or potential sources of sparks in the vicinity of a cooler using **R290** coolant!

⚠ WARNING: After unpacking, place the cooler so that heat created by the cooling unit can be vented sufficiently.

⚠ WARNING: Do not place objects that could prevent air circulation on top of the cooler.

5. INSTALLATION AND PLACEMENT

Place the cooler onto a stable, level surface (maximum permitted inclination: 2 degrees). The appliance requires unobstructed air circulation.

- Ensure sufficient free space for air circulation and heat dissipation.
- Ensure sufficient supply of fresh air.
- The device must not be placed in an enclosed space.
- The device must not be placed in the vicinity of heat sources or exposed to direct sunlight.

Minimum distance of vents from an obstacle that would limit air circulation must be 30 cm. Minimum distance for sections with no air vents is 7 cm. Ideally, use the device in a cool and well ventilated room. The device is designed for use at ambient temperature of at least 16 °C and at most 32 °C.

⚠ WARNING: *The device MUST NOT be used or stored at ambient temperatures lower than 0 °C.* The device is designed for use in a normal environment, under a roof, protected from rain and sunlight. Climate class N.

⚠ DANGER: Protect the cooler and electrical connection from rain and spraying water!

⚠ WARNING: Do not under any circumstances lay the cooler on its side, not even during transport.

i NOTE: In order for the device to work correctly and at maximum output, it is important to not cover up any of the device's vents and ensure sufficient air circulation.

6. ELECTRICAL CONNECTION

Connect the device to a power socket in accordance with specifications on the product label of the device. Electrical wiring is subject to local regulations. If the power leads (cables) are damaged, they must be replaced by the manufacturer, their service technician or a similarly qualified person to prevent risk of hazardous situations.

 **DANGER: Do not use or turn on the device if the power lead (cable) is damaged!**

7. TESTING

The product is delivered ready for immediate use.

8. WARRANTY

The device comes with a warranty in accordance with general legal regulations of the Czech Republic or in accordance with the trade agreement. During the validity period of the warranty, we will remove any defects on the product free of charge, provided these defects were not caused by excess wear, improper handling, incorrect storage or by using the

product in a way that is counter to the instruction manual or the product's design as defined by the manufacturer. Materials replaced during the validity period of the warranty are our property. The legitimacy of the warranty claim is always decided by an authorised service centre. Warranty provided by a retailer outside of the territory of the Czech Republic is governed by the agreement between the retailer and the buyer in their mutual relationship; this agreement is not directly linked to the manufacturer. The agreement does not give the buyer the right to submit warranty claims to the manufacturer. Transport expenses or other costs are not covered by the warranty.

ATTENTION:

Electrical devices and appliances must be checked/inspected at a time stipulated by valid legislation of the country the device is operated in. Inspection of wiring may only be done by a person with valid authorisation for this activity. Service work, provision of spare parts and inspection is done by the manufacturer or an authorised service centre.

9. DEVICE DESCRIPTION

- | | |
|--------------------------|-----------------|
| 1. Drip tray | 7. Condenser |
| 2. LED panel | 8. Light switch |
| 3. Beverage outflow tube | 9. Water inlet |
| 4. Water button | 10. CO2 inlet |
| 5. Soda button | 11. Main switch |
| 6. Power cable | |

figure 7 A

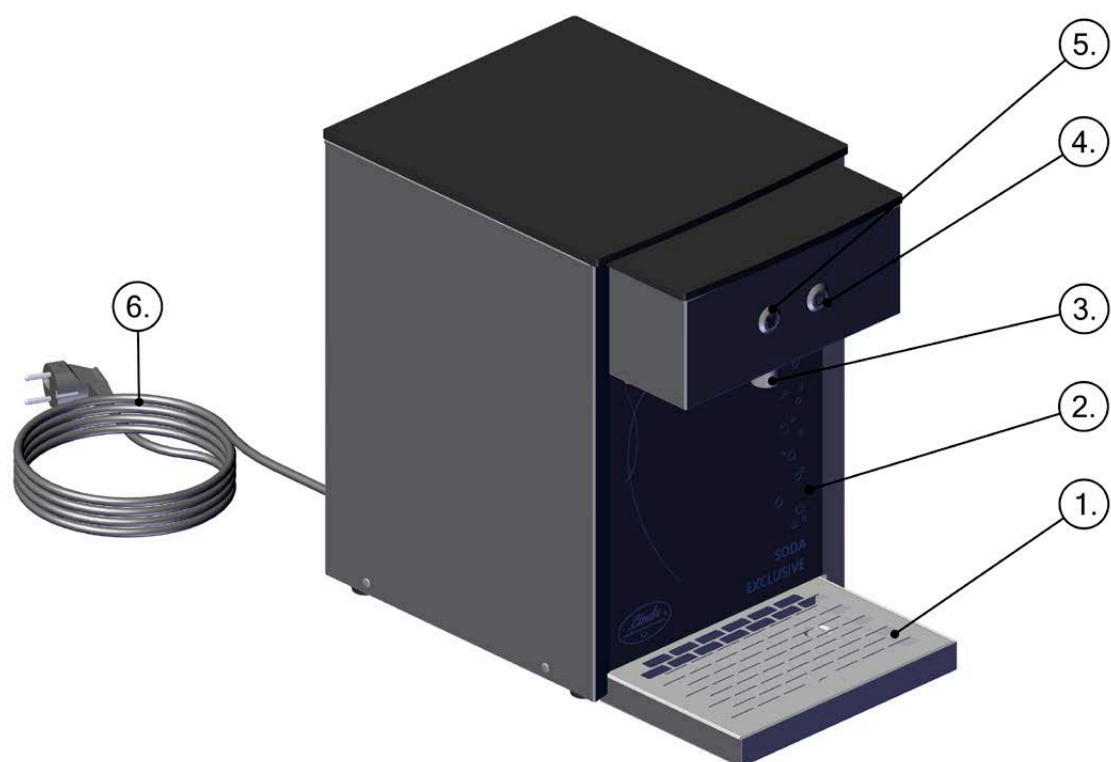
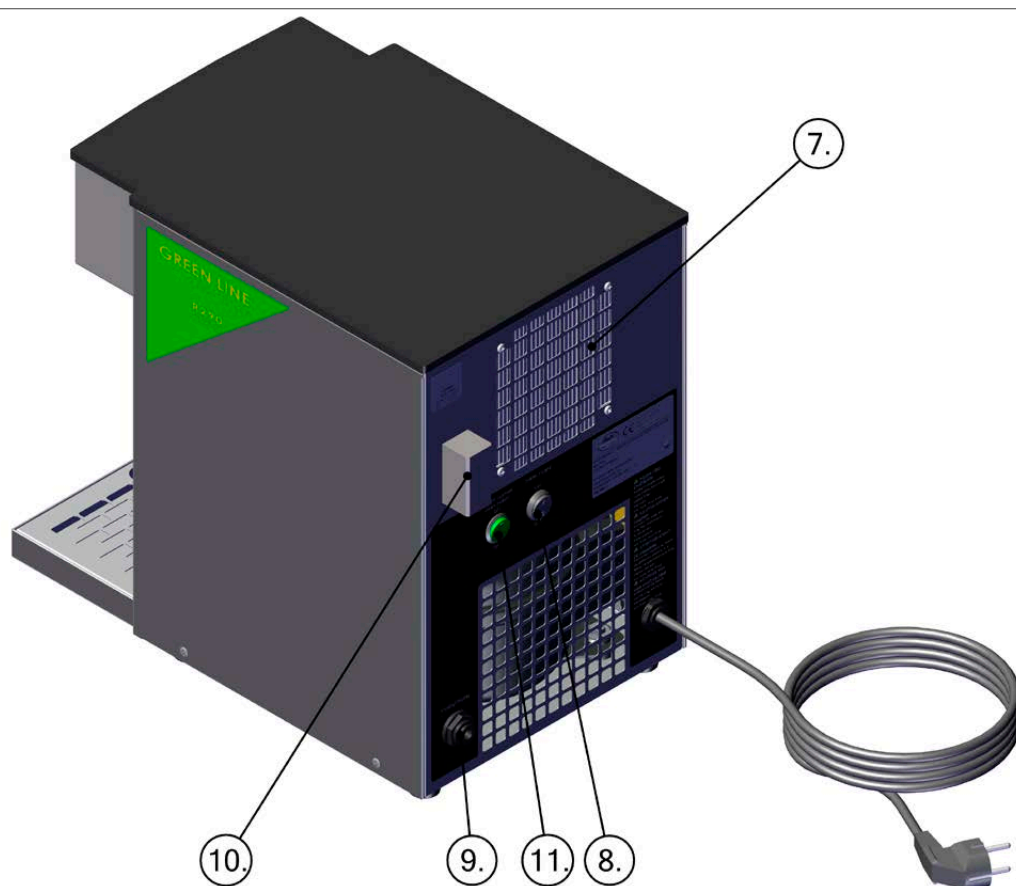

figure 7 B



10. INLET AND OUTLET MARKING

figure 8 A

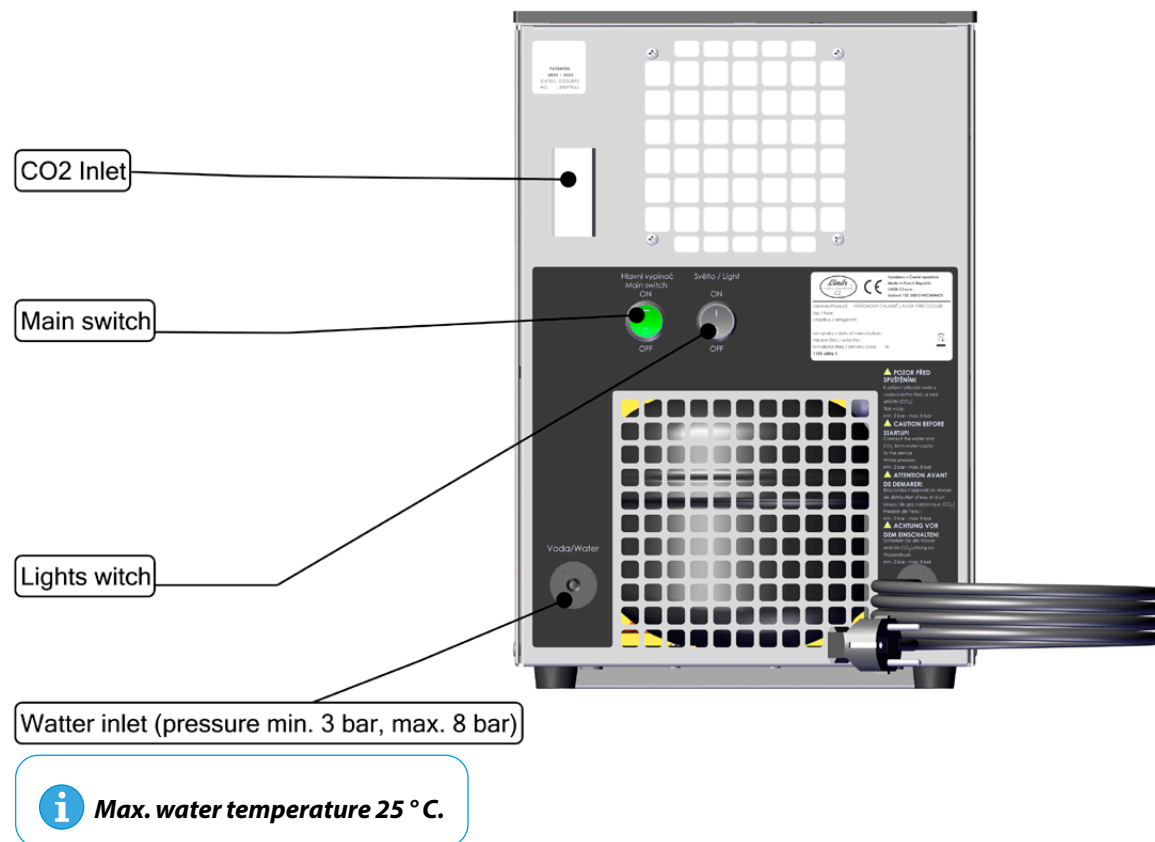
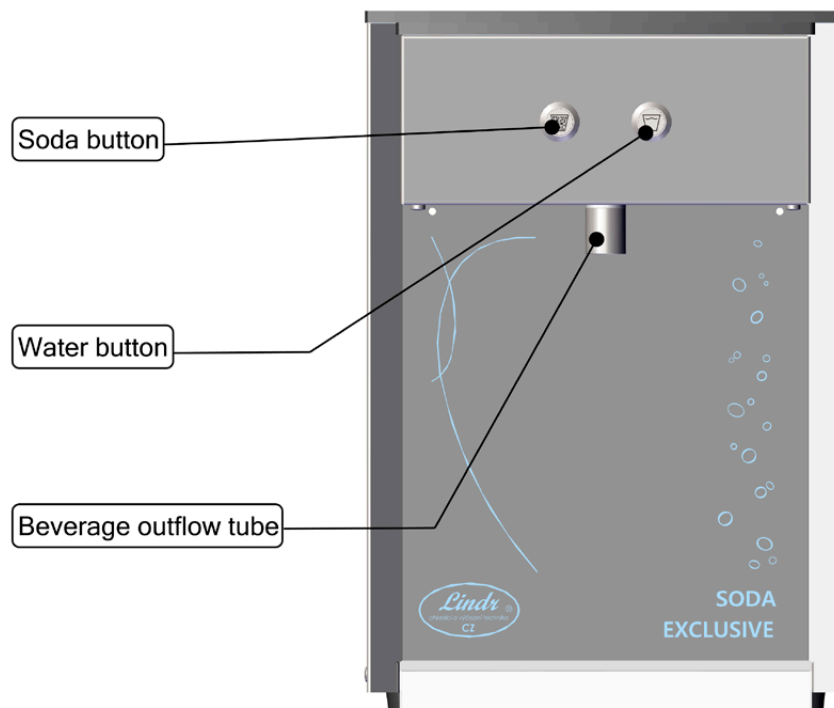

figure 8 B



11. HOW TO WORK WITH SPEED FITTINGS:

11.1 Speed Fittings Installation

figure 9 A

Grasp the rapid coupling and insert the hose all the way inside the speed fitting body (ca. 20 mm). The end of the hose must be straight so that it plugs fully into the coupling. If the hose will not go in, moisten the end of the hose.

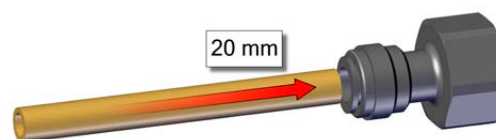

11.2 Speed Fittings Removal

figure 9 B

Hold the grey ring tight against the body of the rapid coupling and pull out the hose.

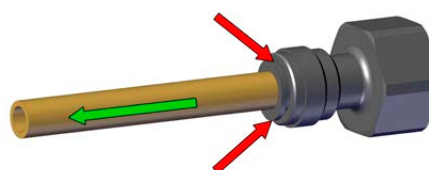

⚠ WARNING: If you do not hold the grey ring but pull at the hose, the speed fitting will cut even deeper into the hose.

⚠ WARNING: Hoses must not be pressurised during removal.

12. PUTTING INTO OPERATION

1. Connect the device to CO₂ supply.
2. Connect the device to water supply.
3. Check that all the joints and connections are sufficiently tight.
4. Connect the device to the power mains.
5. Turn on the device using the main switch.
6. Use the Soda or Water button to pour a drink.

⚠ WARNING: If you discover a leak, turn off the device. Fix any leaks found on the tubing. If a leak is found inside the device or you are unsure how to proceed, contact a service centre.

13. CONNECTING SODA EXCLUSIVE

figure 10 A

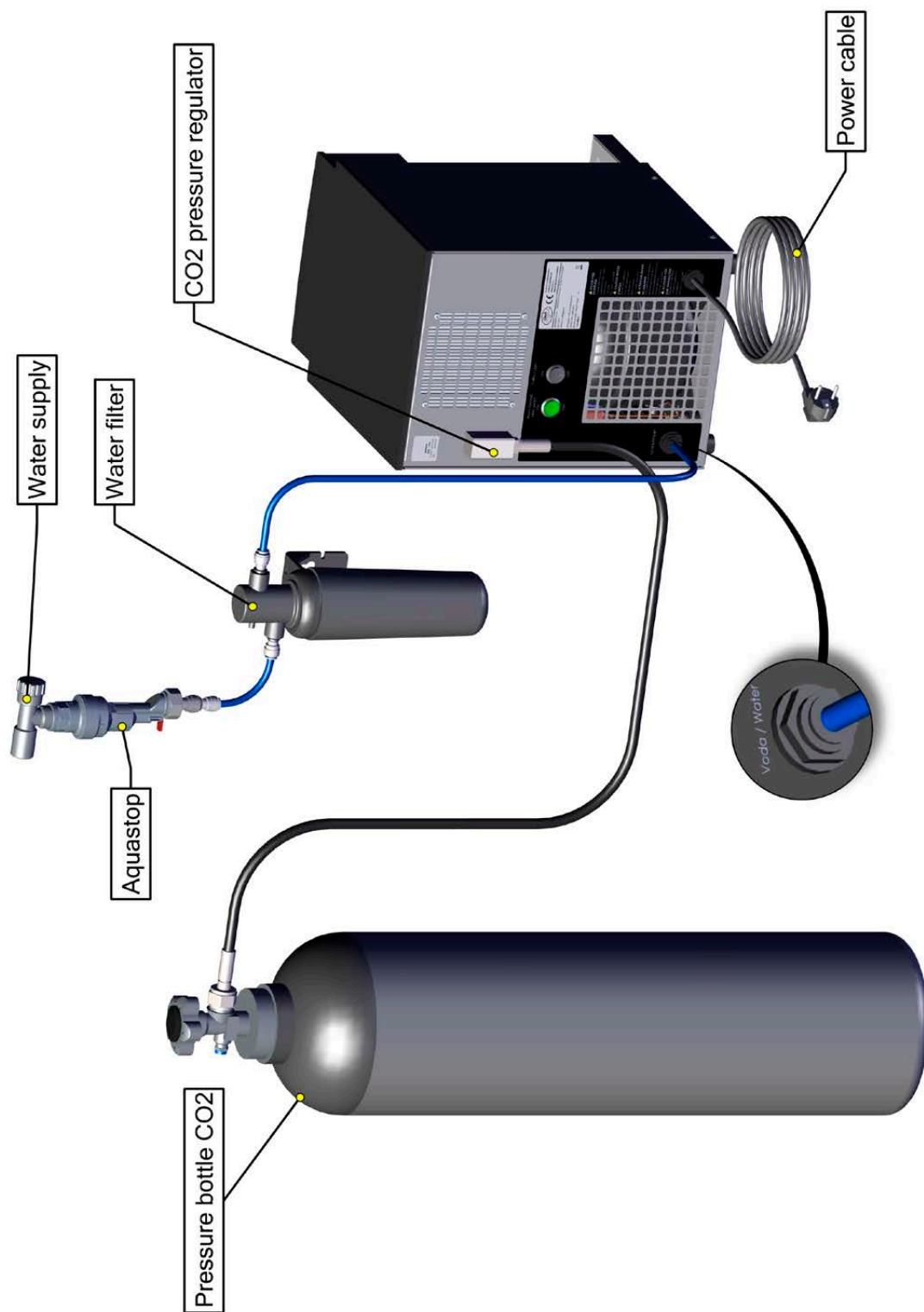

14. RECOMMENDED ACCESSORIES

- AquaStop
- Water filter – VH3-JG 3/8" head
- Water filter – AP3- C 765 S cartridge

i NOTE: The recommended accessories are not included with Soda Exclusive Green Line. The supplier is not liable for damages caused by not using this recommended accessory.

15. CLEANING THE CONDENSER

The condenser must be cleaned with compressed air 1x a month. Alternatively, clean from the outside with a brush.

figure 11 A

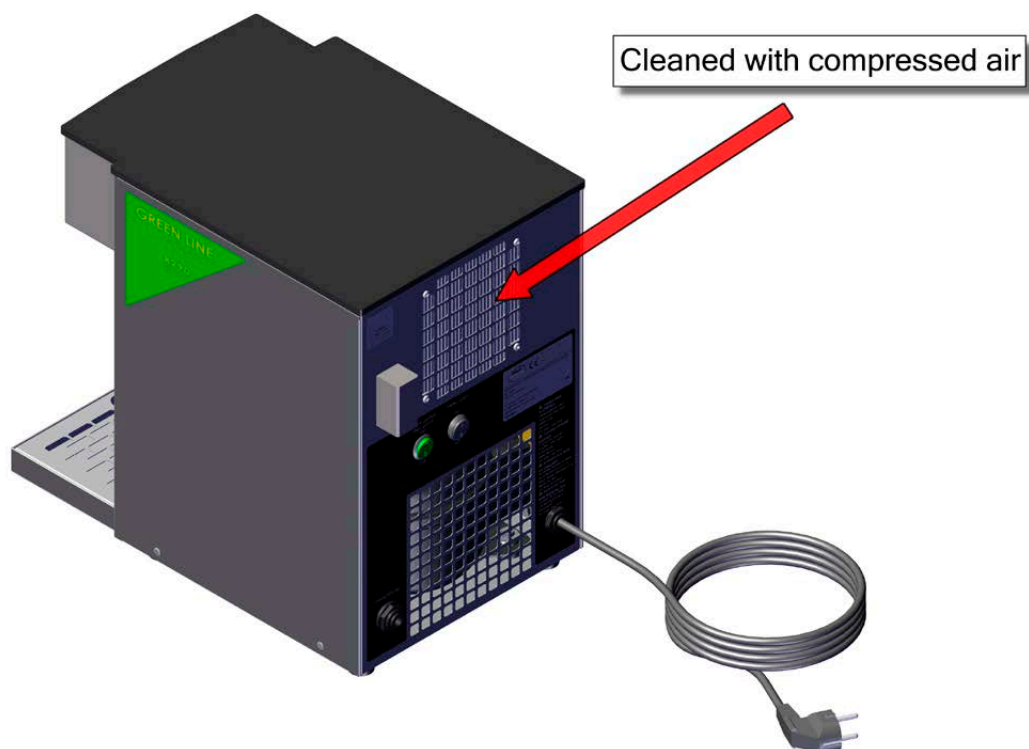

16. TABLE OF MALFUNCTIONS

Malfunction	Cause	Removal
The device is too noisy.	The device is in contact with a foreign object.	Move the object that is touching the device so that it is not in contact with the cooler.
The device does not work.	Power cable is not plugged in. The main switch is off.	Plug in the power cable. Check that the power cable is undamaged. Turn on the main switch.
The device is turned on but does not cool.	The air vents are obstructed.	Make sure the air vents are unobstructed.
Rapid couplings are leaking.	Hose poorly inserted. Scratches on the hose.	Unplug the hose from the rapid coupling and check that it does not have a sharp edge. Shorten the hose with a knife if necessary.



NOTE: If the defect persists even after the above steps are taken, contact a service centre.

Do not forget to specify the following:

- type of defect
- product type
- production year
- product's serial number (found on the label)

Ordering Components

ALWAYS USE ORIGINAL COMPONENTS. The manufacturer or supplier bear no responsibility for non-original components or components not recommended by the manufacturer.

17. SPARE PARTS

When ordering spare parts, always provide the following:

- product type
- production year
- product's serial number
- full name of the spare part and its number

18. TECHNICAL DATA

Name		SODA Exclusive Green Line
Power	(Hp)	1/8
Power	(W)	310
Maximum output	(l/hour)	25
Continuous output	(l/hour)	20
Temperature difference	Δt (°C)	10
Coolant type		R290
Voltage	(V/ Hz~1)	220 – 240 V 50Hz~1
Input power (W)	(W)	391
Current (A)	(A)	1,7
Frame dimensions	(WxDxH mm)	265x370x390
Net weight	(kg)	23

19. INSPECTION BEFORE EVERY USE

1. Visual check.
2. Lead-in cable check.
3. Condenser cleanliness check (in case of excess pollution of the condenser, clean more frequently than 1x a month).

 **WARNING:** Do not use the device if defects or malfunctions are found.

20. PERIODIC CHECKS

- ✓ 1x a week: check that the lead-in cable is undamaged and that the plug is firmly in the socket.
- ✓ 1x a week: check that the device is not exposed to radiant heat.
- ✓ 1x a week: check that air circulation is not obstructed.
- ✓ 1x a month: check the cooling unit's condenser and clean it regularly.
- ✓ 1x a year: have an engineering inspector check the electrical safety of the device.

21. MAINTENANCE

The condenser must be checked for cleanliness every month. Any dirt found must be cleaned with compressed air or wiped off. Otherwise, there is a risk of reduced cooling output or damaging of the cooler.

Wipe the device only with a soft and, if needed, lightly moistened cloth.

22. ENVIRONMENTAL PROTECTION

Waste Sorting



This product must not be disposed of in communal waste. Electrical waste in the Czech Republic is disposed of within the Rema System (www.remasystem.cz).

In countries other than the Czech Republic, waste sorting is subject to local regulations.



Sorted waste enables recycling and reusing used products and packaging materials. Re-use of recycled material helps protect the environment from pollution and reduces resource consumption. Local regulations may regulate the method of disposing household appliances at local collection points or at the point of sale.

